

ROSSO CUTWORK LACE

Printed 13 Feb 2018

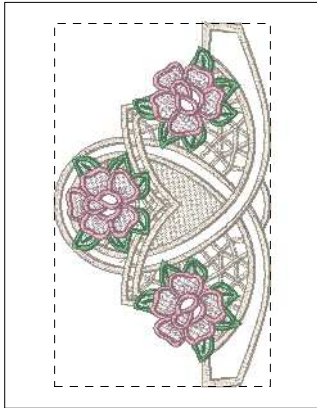

- 1. Placement Line (App:1)
- 2. Cutting Line (App:2)
- 3. Tackdown (App:3)
- 4. Ecu (Mar:1182)
- 5. Light Green (Mar:1272)
- 6. Green (Mar:1124)
- 7. Light Pink (Mar:1019)
- 8. Light Pink (Mar:1020)
- 9. Light Pink (Mar:1022)

Eecw01.art60

106.40x178.70 mm; 31,202 stitches
9 thread changes; 9 colors

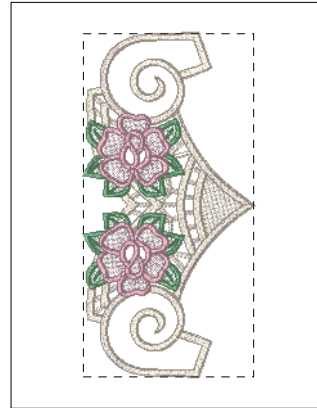

- 1. Placement Line (App:1)
- 2. Cutting Line (App:2)
- 3. Tackdown (App:3)
- 4. Ecu (Mar:1182)
- 5. Light Green (Mar:1272)
- 6. Green (Mar:1124)
- 7. Light Pink (Mar:1019)
- 8. Light Pink (Mar:1020)
- 9. Light Pink (Mar:1022)

Eecw02.art60

83.90x168.80 mm; 19,807 stitches
9 thread changes; 9 colors

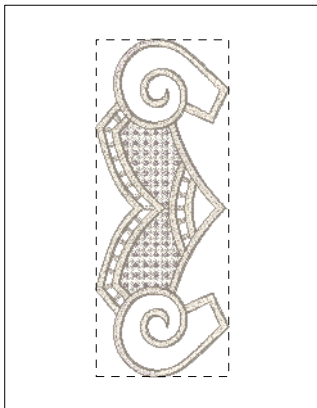

- 1. Placement Line (App:1)
- 2. Cutting Line (App:2)
- 3. Tackdown (App:3)
- 4. Ecu (Mar:1182)
- 5. Light Pink (Mar:1019)
- 6. Ecu (Mar:1182)

Eecw03.art60

65.40x165.60 mm; 11,383 stitches
6 thread changes; 5 colors

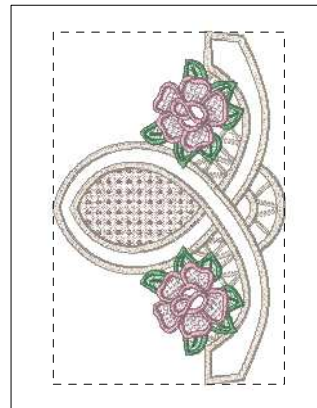

- 1. Placement Line (App:1)
- 2. Cutting Line (App:2)
- 3. Tackdown (App:3)
- 4. Ecu (Mar:1182)
- 5. Light Pink (Mar:1022)
- 6. Ecu (Mar:1182)
- 7. Light Green (Mar:1272)
- 8. Green (Mar:1124)
- 9. Light Pink (Mar:1019)
- 10. Light Pink (Mar:1020)
- 11. Light Pink (Mar:1022)

Eecw04.art60

113.80x173.00 mm; 22,656 stitches
11 thread changes; 9 colors

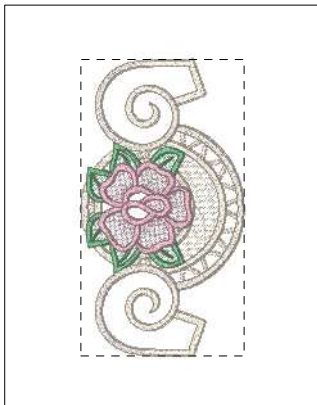

- 1. Placement Line (App:1)
- 2. Cutting Line (App:2)
- 3. Tackdown (App:3)
- 4. Ecu (Mar:1182)
- 5. Light Green (Mar:1272)
- 6. Green (Mar:1124)
- 7. Light Pink (Mar:1019)
- 8. Light Pink (Mar:1020)
- 9. Light Pink (Mar:1022)

Eecw05.art60

80.20x145.90 mm; 14,893 stitches
9 thread changes; 9 colors

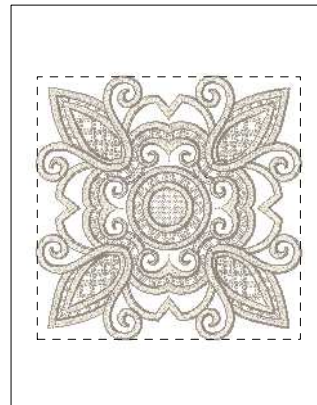

- 1. Placement Line (App:1)
- 2. Cutting Line (App:2)
- 3. Tackdown (App:3)
- 4. Ecu (Mar:1182)

Eecw06.art60

129.50x129.40 mm; 27,761 stitches
4 thread changes; 4 colors

ROSSO CUTWORK LACE

Printed 13 Feb 2018

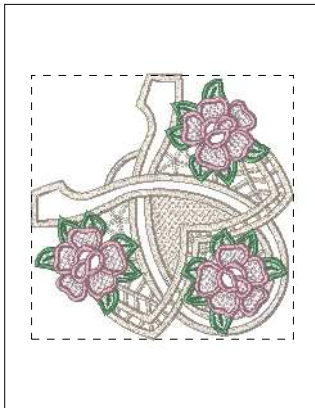

- 1. Placement Line (App:1)
- 2. Cutting Line (App:2)
- 3. Tackdown (App:3)
- 4. Ecu (Mar:1182)
- 5. Light Green (Mar:1272)
- 6. Green (Mar:1124)
- 7. Light Pink (Mar:1019)
- 8. Light Pink (Mar:1020)
- 9. Light Pink (Mar:1022)

Eecwl07.art60

128.90x129.90 mm; 29,002 stitches
9 thread changes; 9 colors

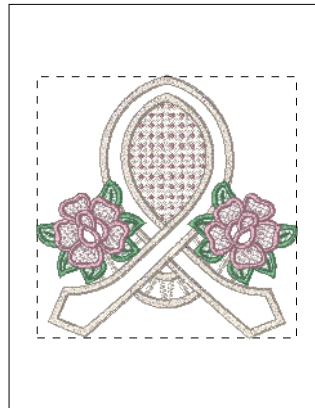

- 1. Placement Line (App:1)
- 2. Cutting Line (App:2)
- 3. Tackdown (App:3)
- 4. Ecu (Mar:1182)
- 5. Light Pink (Mar:1022)
- 6. Ecu (Mar:1182)
- 7. Light Green (Mar:1272)
- 8. Green (Mar:1124)
- 9. Light Pink (Mar:1019)
- 10. Light Pink (Mar:1020)
- 11. Light Pink (Mar:1022)

Eecwl08.art60

127.70x128.70 mm; 20,638 stitches
11 thread changes; 9 colors



- 1. Placement Line (App:1)
- 2. Cutting Line (App:2)
- 3. Tackdown (App:3)
- 4. Ecu (Mar:1182)
- 5. Light Green (Mar:1272)
- 6. Green (Mar:1124)
- 7. Light Pink (Mar:1019)
- 8. Light Pink (Mar:1020)
- 9. Light Pink (Mar:1022)

Eecwl09.art60

129.50x129.40 mm; 31,225 stitches
9 thread changes; 9 colors



- 1. Placement Line (App:1)
- 2. Cutting Line (App:2)
- 3. Tackdown (App:3)
- 4. Ecu (Mar:1182)
- 5. Light Green (Mar:1272)
- 6. Green (Mar:1124)
- 7. Light Pink (Mar:1019)
- 8. Light Pink (Mar:1020)
- 9. Light Pink (Mar:1022)

Eecwl10.art60

128.70x128.60 mm; 35,631 stitches
9 thread changes; 9 colors